

YOUR FUTURE OFFICE

OXFLORD

Leasing Opportunity at

Bow Valley Square - II

Suite Details:

Tower
Bow Valley Square II

Suite Number
1800

Square Footage
13,560

Further Information

[Bow Valley Square's Webpage](#)

Website

[OxfordProperties.com](#)

Suite Description

- Full floor opportunity
- 17 exterior offices
- Two meeting rooms
- Large boardroom
- Open area for 55 workstations
- Kitchen, storage and copy area

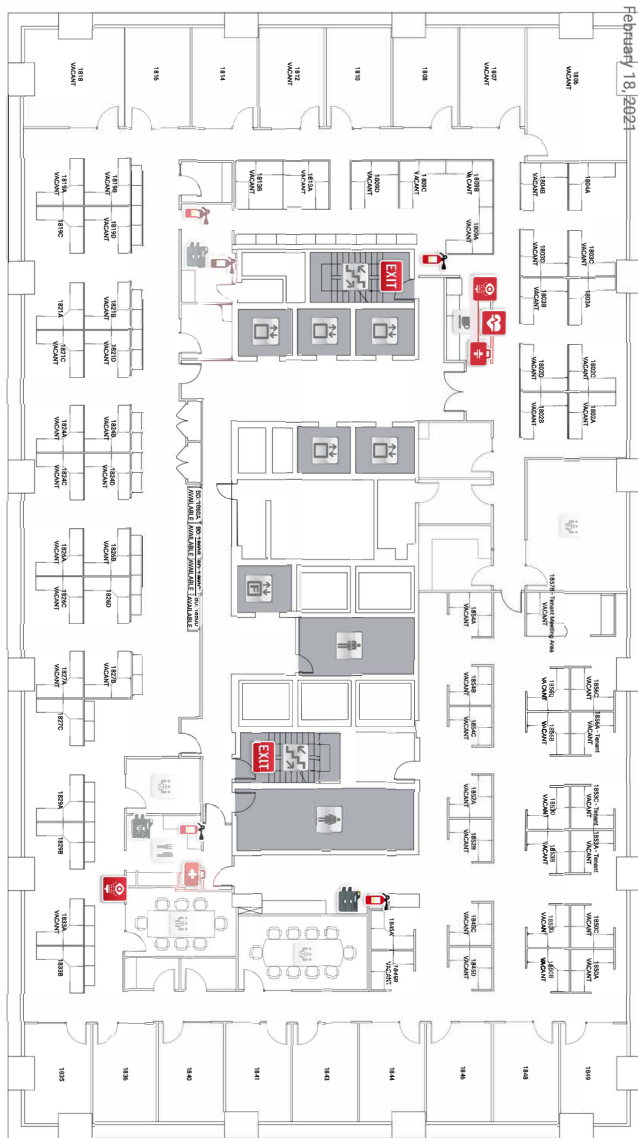

Plan View of Your Suite,
Suite 1800, Bow Valley Square II

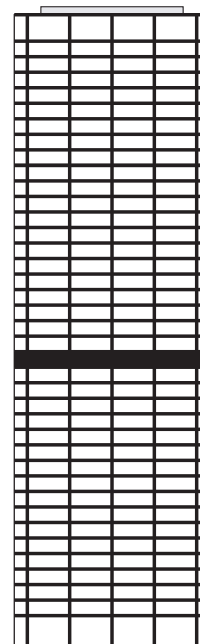

Your Suite



Your Office Tower

A workplace experience

designed for the way
you live



7:00 AM

Get energized with a BVS Peleton bike workout in our convenient on-site fitness centre



8:15 AM

Fuel your morning with a steaming nalog brew, then let the creative juices flow in your clean, bright workspace

12:00 PM

Grab a BVS picnic blanket and lunch from Holy Grill for a restorative lunch in the sun

3:00 PM

Take a 15-minute brain break with some ping-pong on the rooftop patio



4:30 PM

Head out to Wine Not Wednesday at the BVS tenant HUB and meet your neighbours

Bow Valley Square

Curated for work and life

OXFORD